

COMPANY: \_\_\_\_\_  
 \_\_\_\_\_  
 \_\_\_\_\_  
 ATTN: \_\_\_\_\_  
 PHONE: \_\_\_\_\_  
 FAX: \_\_\_\_\_

**DATA SHEET**  
**MODEL "A-SM1"**  
**FALLGUARD®**  
**SKYLIGHT SCREENS**  
 FAX 713-453-8372

**DATA SHEET**  
**FGA-7**  
 6-27-05

**Model A-SM1 FALLGUARD® Skylight Screen**

Patent No. 5,237,788

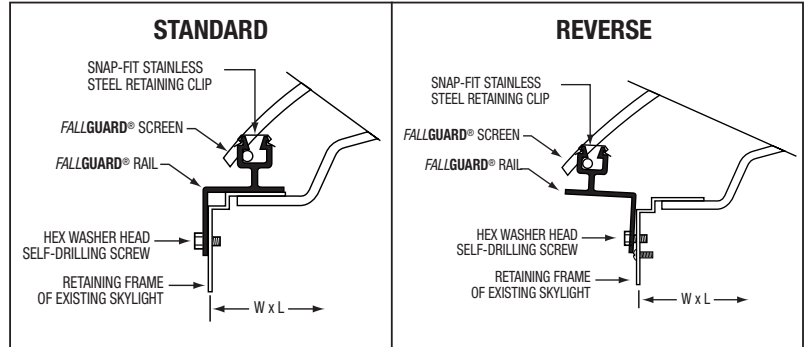
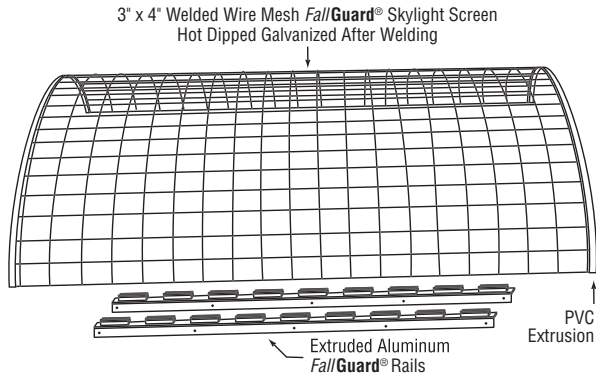

Shown below are some typical retaining frame profiles. Upon receipt of the quantity and dimensions of the clamp, Plasteco, Inc. can readily submit a quotation.

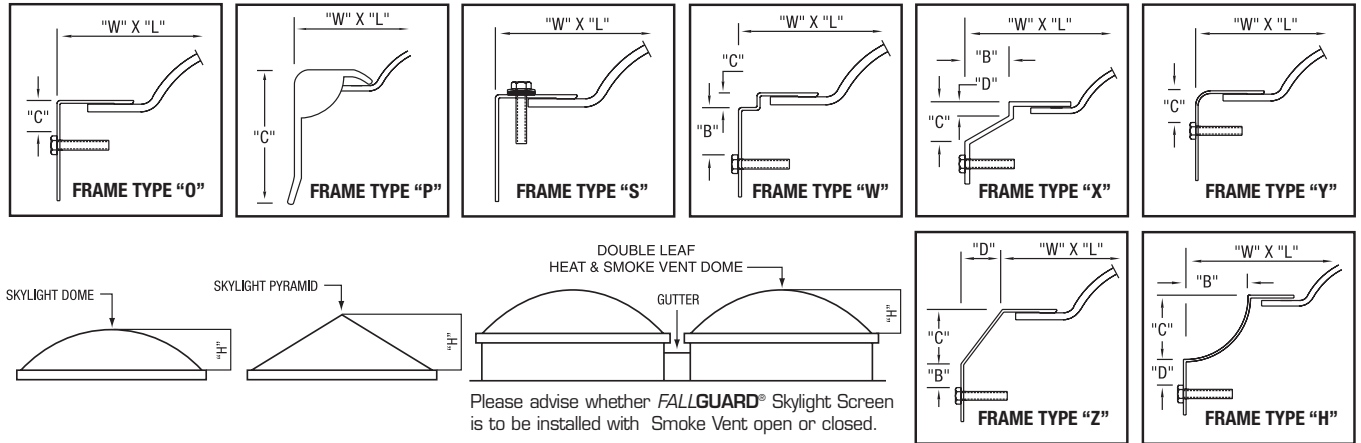

**IF YOU WISH A FAXED QUOTATION, PLEASE ENTER RETAINING FRAME DATA HERE AND FAX TO PLASTECO, INC.**

FRAME TYPE	DIMENSION "W" x "L"	DIMENSION "B"	DIMENSION "C"	DIMENSION "D"	DOME/PYRAMID "H"	QUANTITY

**Specifications:**

Skylight Screens shall be Model A-SM1 FALLGUARD® Skylight Screens as manufactured by Plasteco, Inc., Houston, Texas (1-800-231-6117) (Fax 713-453-8372). The FALLGUARD® Skylight Screen rail shall be fastened to the vertical leg of the retaining frame of the skylight to be retrofitted with galvanized #12 hex washer head self-drilling screw. The FALLGUARD® Skylight Screen shall be 3" x 4" welded steel wire mesh having a minimum transverse (or in the case of a square skylight the curved wire) diameter of .195". The screen shall be hot dipped galvanized to meet ASTM A123 specifications. The FALLGUARD® rails shall be 6061-T6 extruded aluminum with 2" wide notches on 4" centers. After the FALLGUARD® Skylight Screen is installed, a series of 2" wide by 1/2" tall scuppers are created. Where the FALLGUARD® Skylight Screen is longer than the FALLGUARD® rail, a continuous 1/2" opening is created. The exposed ends of the FALLGUARD® Skylight Screen shall be covered with a outdoor PVC extrusion.

**Installation Instructions:**

Skylight can be brittle. Do Not Touch Dome.  
 Wear gloves when handling screen. Wear safety glasses when installing FALLGUARD® Rail.

1. Center FALLGUARD® Rail on the retaining frame.
2. Secure the FALLGUARD® Rail with self-drilling special stainless steel hex washer head screws to the retaining frame of the skylight being retrofitted.
3. Install FALLGUARD® Skylight Screen into the FALLGUARD® Rail opening.
4. Install stainless steel clips.